

Providence R.I.  
 This plat accompanies  
 our report of this date.

# PLAT OF EXCHANGE STREET FROM WESTMINSTER ST. TO EXCHANGE PLACE

SCALE 20 FEET PER INCH.

Note, The northeasterly line of Exchange street as hereby fixed, is indicated by the station distances and offsets referred to the straight line CD, being straight from point opposite to station 0.00 at Exchange place to corner of underpinning at station 103.14, - thence following the underpinning to its intersection with the line CD near station 190.0 and thence in said line CD to Westminster street.

Stations and offsets in red show outer construction of building as standing March 1900.

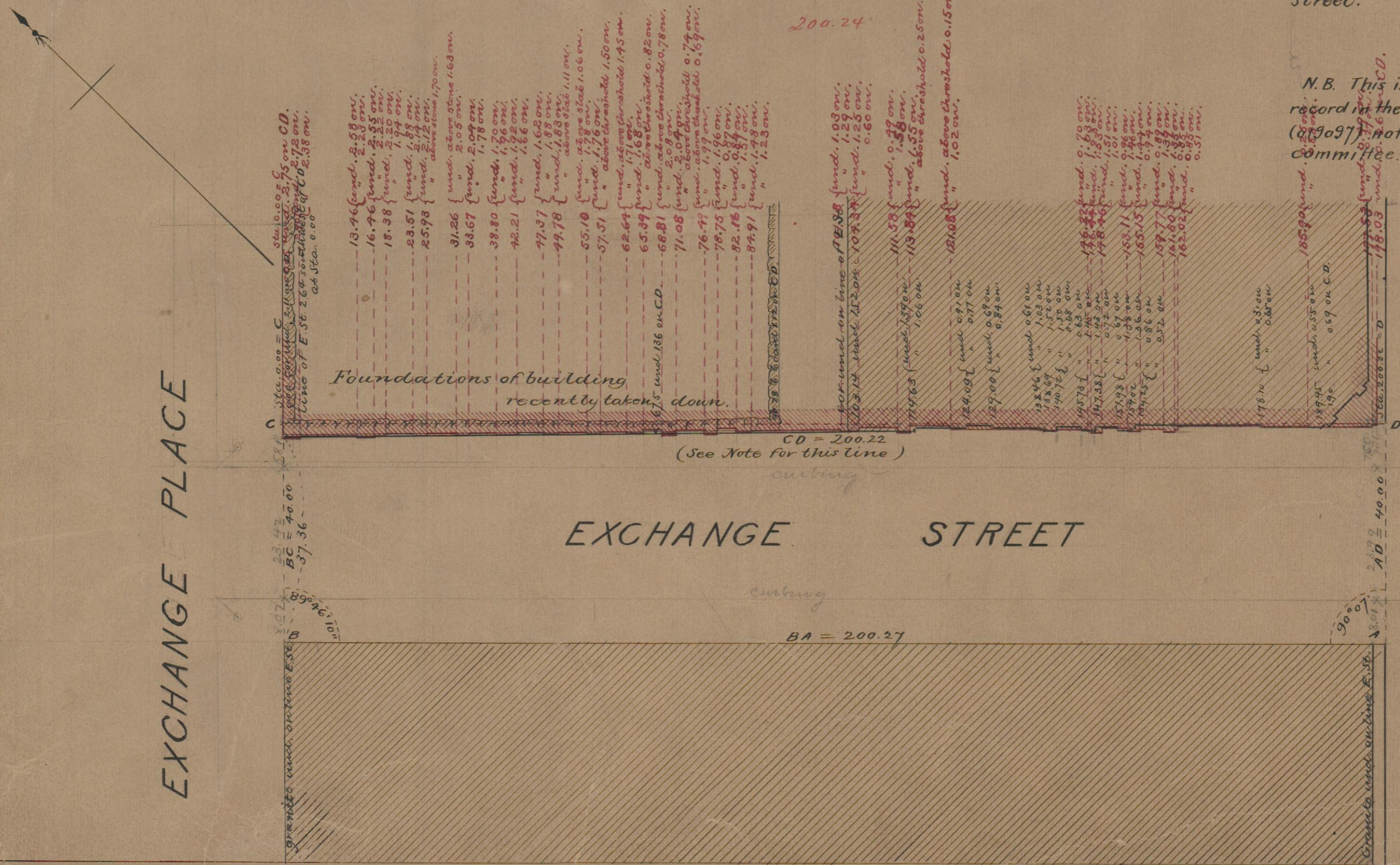

N.B. This is copied from the map (019098) on record in the city clerk's office, the original map (019097) not having been returned by the Committee.

EXCHANGE PLACE  
 WESTMINSTER STREET

84  
 B-12